



DRAPER, UTAH
(801) 990-1775
WWW.VECTORSOLAR.COM

Copyright © 2020
Vector Structural Engineering, LLC
This drawing contains proprietary information belonging to Vector Structural Engineering, LLC, and may be neither wholly nor partially copied or reproduced without the prior written permission of Vector Structural Engineering, LLC.

INSTRUCTIONS &
SURVEY TYPE: GENERAL INFORMATION

RESIDENTIAL SOLAR SITE SURVEY

COMPANY NAME: _____ DATE: _____

INSTRUCTIONS:

1. Fill out this first page once per project.
2. Fill out one of the following survey forms for each unique roof plane that will be supporting the solar array.
3. Completely fill out the survey forms. Incomplete forms will delay our analysis and will be sent back to be completed.
4. PHOTOS ARE REQUIRED. (See photo checklist below.) The lack of photos will delay our analysis and will be requested if missing.
5. For ideas on how to gather information when the roof framing is not accessible due to finished ceilings, contact your Vector Point of Contact (POC).

PROJECT INFORMATION:

Project Name: _____ Address: _____
City: _____ State/Zip: _____

PHOTO CHECKLIST: (Photos are required)

- Exterior elevation photos showing all (4) sides of the structure.
- Interior attic photos of each roof plane supporting the solar array:
 - Photos with tape measure showing the framing depth
 - Photos with tape measure showing the framing width
 - Photos with tape measure showing the framing spacing
 - Photos showing the framing from a distance
- Photos of the roofing from above for metal roofs

PANEL LAYOUT:

- Provide a roof plan showing the solar panel locations.

ROOF / FRAMING CONDITION:

Check the boxes below for any observed damage to the framing. If damage was observed, please describe below and provide photos of the damage.

- Dry Rot
 - Splits, Cuts, or Breaks
 - Visible Sagging
 - Water Damage
 - Smoke or Fire Damage
 - Other _____
- Describe Damage: _____

If you have questions, please call Vector Structural Engineering at (800) 558-0013.

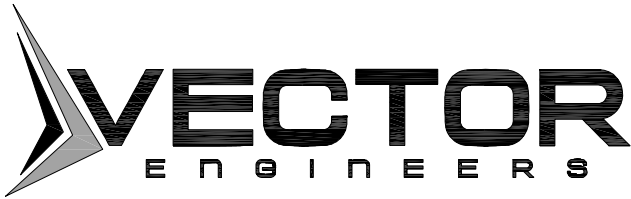

DRAPER, UTAH
 (801) 990-1775
 WWW.VECTORSOLAR.COM

Copyright © 2020
 Vector Structural Engineering, LLC
 This drawing contains proprietary information belonging to
 Vector Structural Engineering, LLC, and may be neither
 wholly nor partially copied or reproduced without the prior
 written permission of Vector Structural Engineering, LLC.

SURVEY TYPE: RAFTER & CEILING JOIST
 ATTIC SPACE UNFINISHED

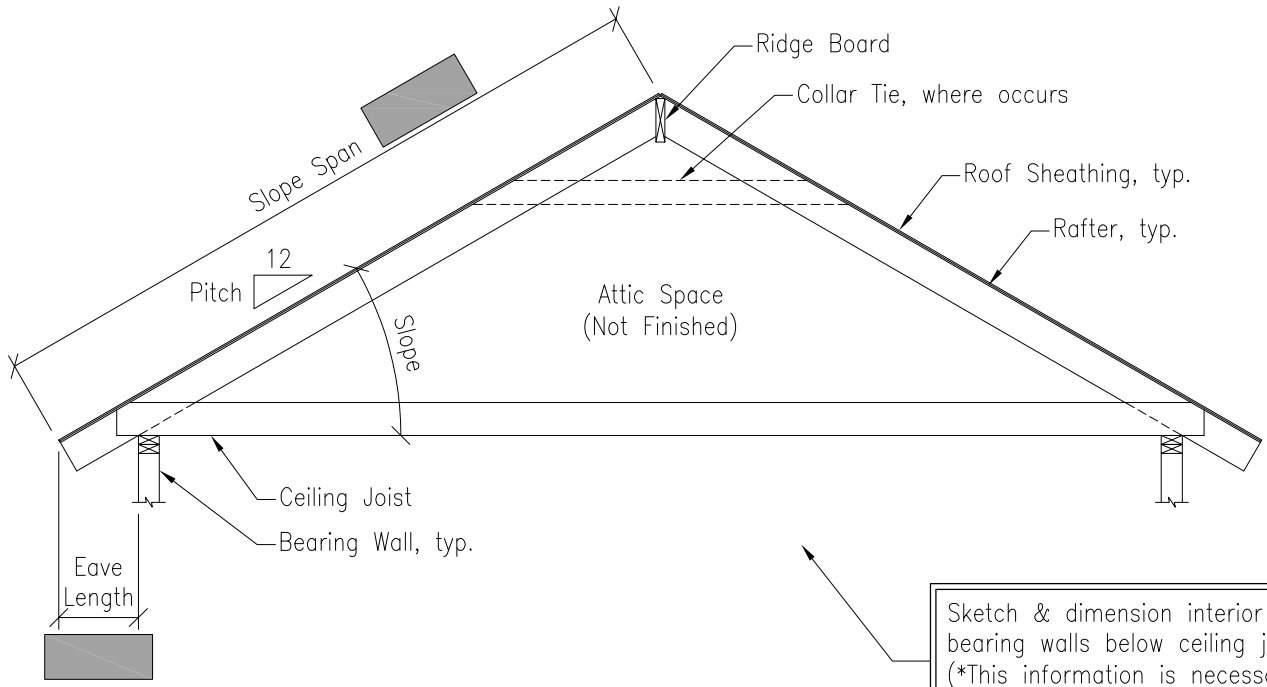

Sketch & dimension interior bearing walls below ceiling joists (*This information is necessary if a knee wall retrofit is required.)

Roof Label/Identifier: _____

Roof Finish:	Slope:
<input type="checkbox"/> Asphalt/Composite Shingles <input type="checkbox"/> Metal Seam <input type="checkbox"/> Corrugated Metal <input type="checkbox"/> Concrete Tile <input type="checkbox"/> Clay Tile <input type="checkbox"/> Other: _____	Pitch: _____ /12 OR Slope: _____ degrees

Rafter:	Ceiling Joist:	Collar Tie:
<u>Size:</u> <input type="checkbox"/> 2x4 <input type="checkbox"/> 2x6 <input type="checkbox"/> 2x8 <input type="checkbox"/> 2x10 <input type="checkbox"/> 2x12 <input type="checkbox"/> Other: _____ <u>Spacing:</u> <input type="checkbox"/> 16" o.c. <input type="checkbox"/> 24" o.c. <input type="checkbox"/> Other: _____ <u>Grade:</u> (if possible) _____	<u>Size:</u> <input type="checkbox"/> 2x4 <input type="checkbox"/> 2x6 <input type="checkbox"/> 2x8 <input type="checkbox"/> 2x10 <input type="checkbox"/> 2x12 <input type="checkbox"/> Other: _____ <u>Spacing:</u> <input type="checkbox"/> 16" o.c. <input type="checkbox"/> 24" o.c. <input type="checkbox"/> Other: _____ <u>Grade:</u> (if possible) _____	<u>Size:</u> <input type="checkbox"/> No Collar Tie <input type="checkbox"/> 2x4 <input type="checkbox"/> 2x6 <input type="checkbox"/> 2x8 <input type="checkbox"/> Other: _____ <u>Spacing:</u> <input type="checkbox"/> 16" o.c. <input type="checkbox"/> 24" o.c. <input type="checkbox"/> 32" o.c. <input type="checkbox"/> 48" o.c. <input type="checkbox"/> Other: _____ <u>Grade:</u> (if possible) _____

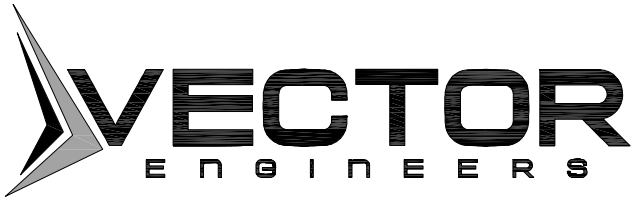

DRAPER, UTAH
(801) 990-1775
WWW.VECTORSOLAR.COM

Copyright © 2020
 Vector Structural Engineering, LLC
 This drawing contains proprietary information belonging to
 Vector Structural Engineering, LLC, and may be neither
 wholly nor partially copied or reproduced without the prior
 written permission of Vector Structural Engineering, LLC.

RAFTER & CEILING JOIST
 w/ PURLIN & PURLIN BRACES
 ATTIC SPACE UNFINISHED

SURVEY TYPE: _____

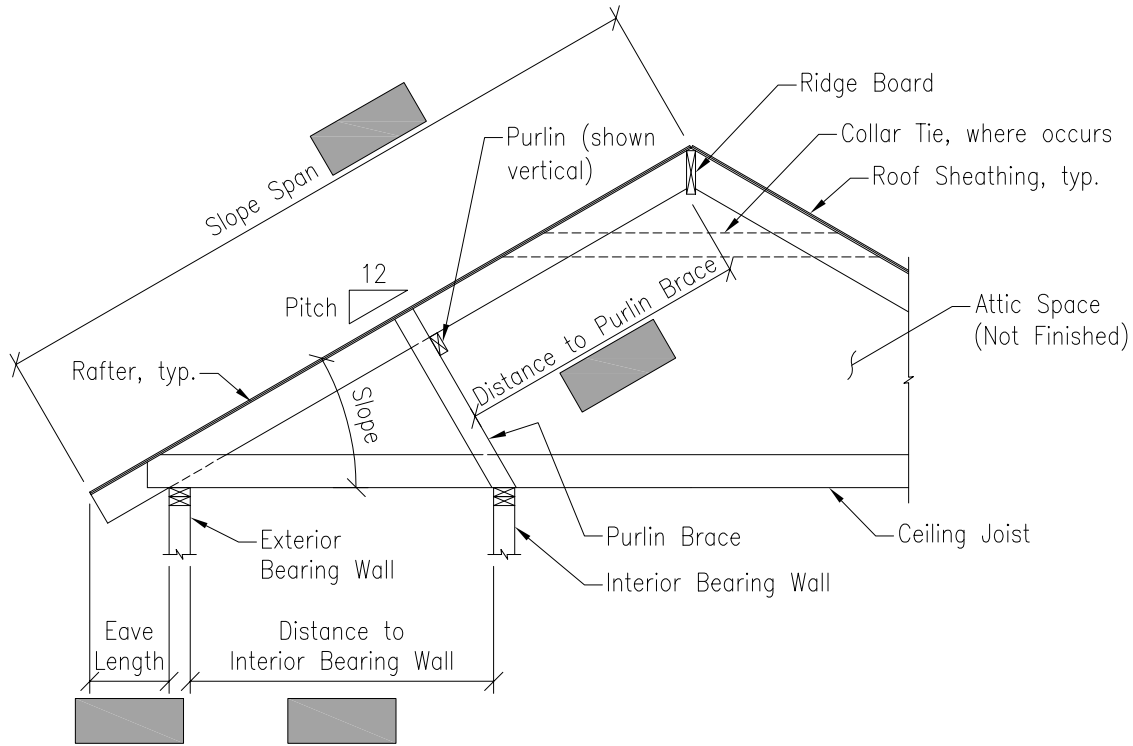

Roof Label/Identifier: _____

Roof Finish: <input type="checkbox"/> Asphalt/Composite Shingles <input type="checkbox"/> Metal Seam <input type="checkbox"/> Corrugated Metal <input type="checkbox"/> Concrete Tile <input type="checkbox"/> Clay Tile <input type="checkbox"/> Other: _____	Slope: _____ Pitch: _____ /12 OR Slope: _____ degrees
--	--

Rafter: Size: <input type="checkbox"/> 2x4 <input type="checkbox"/> 2x6 <input type="checkbox"/> 2x8 <input type="checkbox"/> 2x10 <input type="checkbox"/> 2x12 <input type="checkbox"/> Other: _____ Spacing: <input type="checkbox"/> 16" o.c. <input type="checkbox"/> 24" o.c. <input type="checkbox"/> Other: _____ Grade: (if possible) _____	Ceiling Joist: Size: <input type="checkbox"/> 2x4 <input type="checkbox"/> 2x6 <input type="checkbox"/> 2x8 <input type="checkbox"/> 2x10 <input type="checkbox"/> 2x12 <input type="checkbox"/> Other: _____ Spacing: <input type="checkbox"/> 16" o.c. <input type="checkbox"/> 24" o.c. <input type="checkbox"/> Other: _____ Grade: (if possible) _____	Collar Tie: Size: <input type="checkbox"/> No Collar Tie <input type="checkbox"/> 2x4 <input type="checkbox"/> 2x6 <input type="checkbox"/> 2x8 <input type="checkbox"/> Other: _____ Spacing: <input type="checkbox"/> 16" o.c. <input type="checkbox"/> 24" o.c. <input type="checkbox"/> 32" o.c. <input type="checkbox"/> 48" o.c. <input type="checkbox"/> Other: _____ Grade: (if possible) _____	Purlin: Size: _____ Orientation: <input type="checkbox"/> 2x4 <input type="checkbox"/> Flat <input type="checkbox"/> 2x6 <input type="checkbox"/> Vertical <input type="checkbox"/> Other: _____ Grade: (if possible) _____ Purlin Brace: Size: _____ Spacing: <input type="checkbox"/> 2x4 <input type="checkbox"/> 16" o.c. <input type="checkbox"/> 2x6 <input type="checkbox"/> 24" o.c. <input type="checkbox"/> Other: _____ <input type="checkbox"/> 32" o.c. Grade: (if possible) <input type="checkbox"/> 48" o.c. _____ <input type="checkbox"/> Other: _____
--	---	--	--

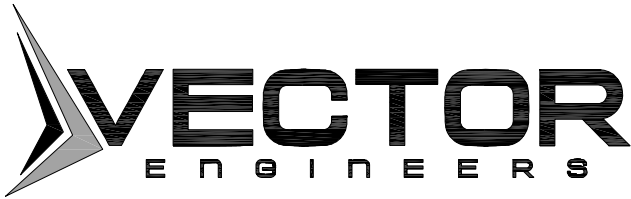

DRAPER, UTAH
 (801) 990-1775
 WWW.VECTORSOLAR.COM

Copyright © 2020
 Vector Structural Engineering, LLC
 This drawing contains proprietary information belonging to
 Vector Structural Engineering, LLC, and may be neither
 wholly nor partially copied or reproduced without the prior
 written permission of Vector Structural Engineering, LLC.

SURVEY TYPE: RAFTER FINISHED CEILING

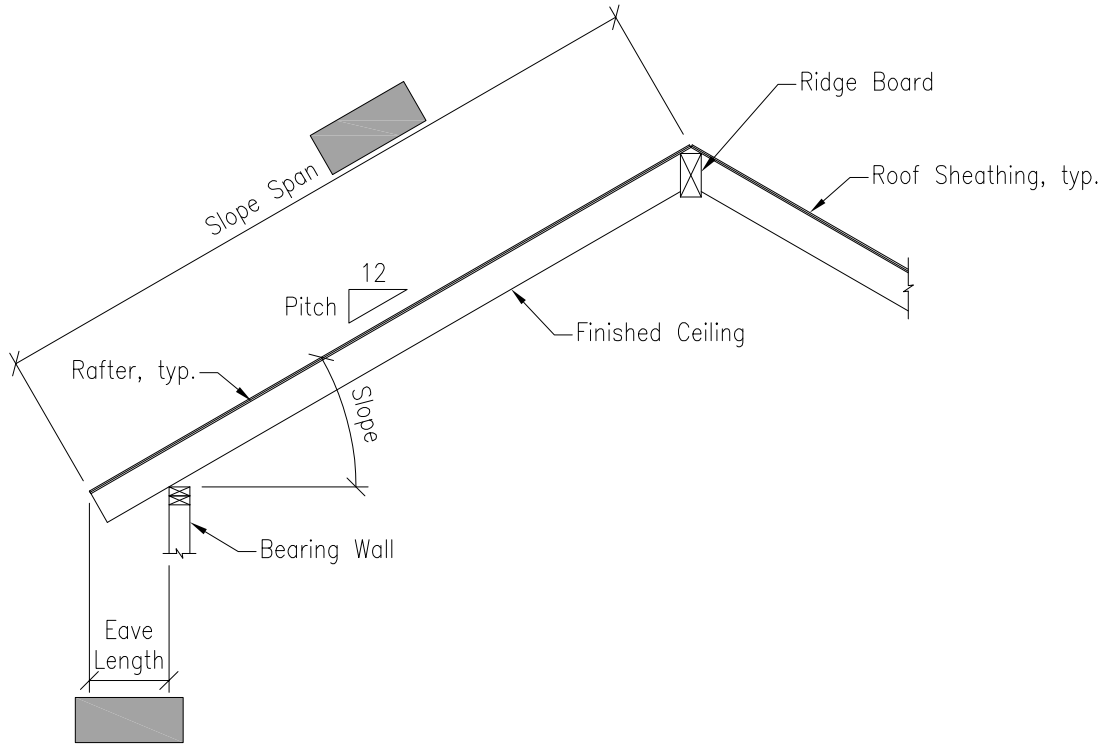

Roof Label/Identifier: _____

Roof Finish:		Slope:
<input type="checkbox"/> Asphalt/Composite Shingles <input type="checkbox"/> Metal Seam <input type="checkbox"/> Corrugated Metal <input type="checkbox"/> Concrete Tile <input type="checkbox"/> Clay Tile <input type="checkbox"/> Other: _____		Pitch: _____ /12 OR Slope: _____ degrees
Rafter:	Ridge Beam:	
Size: <input type="checkbox"/> 2x4 <input type="checkbox"/> 2x6 <input type="checkbox"/> 2x8 <input type="checkbox"/> 2x10 <input type="checkbox"/> 2x12 <input type="checkbox"/> Other: _____	Size: _____ Grade: (if possible) _____	
Spacing: <input type="checkbox"/> 16" o.c. <input type="checkbox"/> 24" o.c. <input type="checkbox"/> Other: _____		
Grade: (if possible) _____		



DRAPER, UTAH
 (801) 990-1775
 WWW.VECTORSOLAR.COM

Copyright © 2020
 Vector Structural Engineering, LLC
 This drawing contains proprietary information belonging to
 Vector Structural Engineering, LLC, and may be neither
 wholly nor partially copied or reproduced without the prior
 written permission of Vector Structural Engineering, LLC.

SURVEY TYPE: RAFTER & FLOOR JOIST
 ATTIC SPACE FINISHED

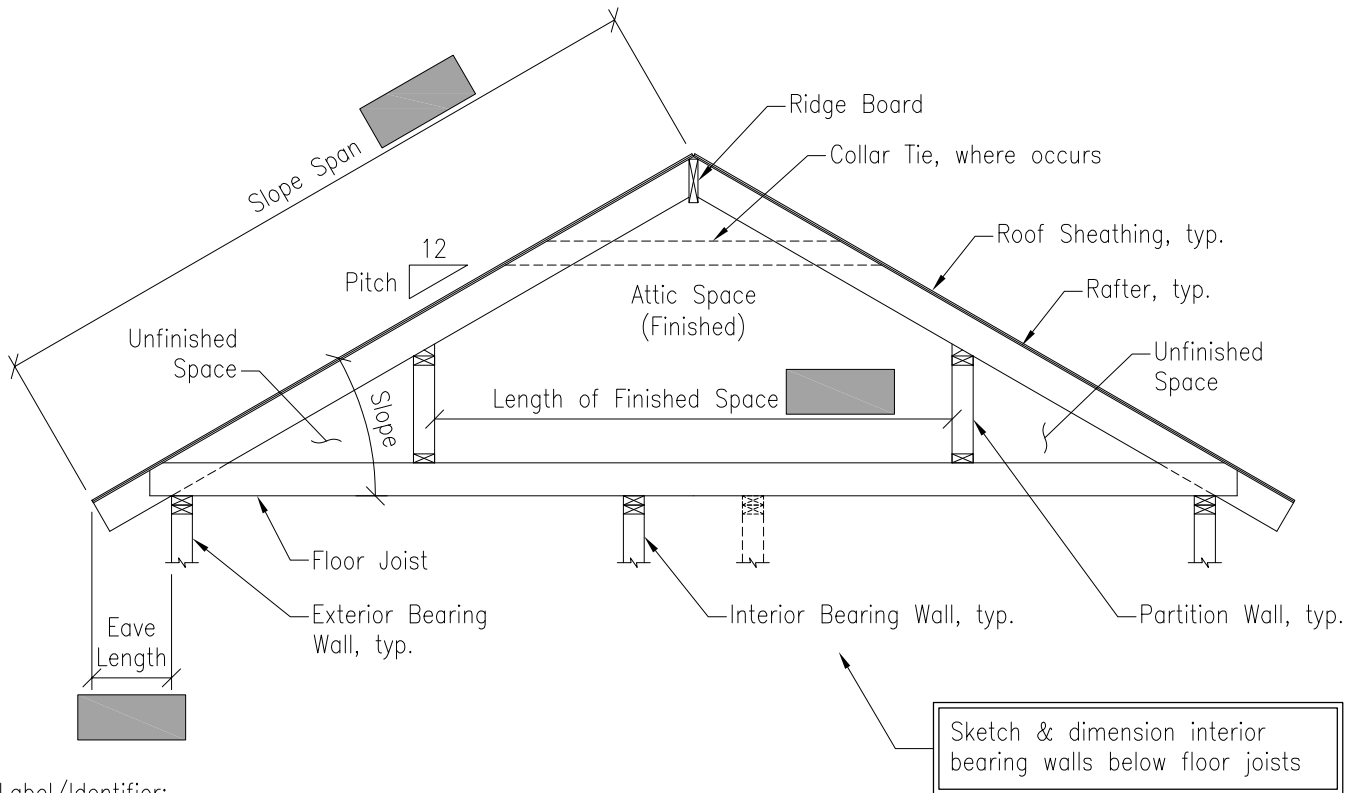

Roof Label/Identifier: _____

Roof Finish: <input type="checkbox"/> Asphalt/Composite Shingles <input type="checkbox"/> Metal Seam <input type="checkbox"/> Corrugated Metal <input type="checkbox"/> Concrete Tile <input type="checkbox"/> Clay Tile <input type="checkbox"/> Other: _____	Slope: Pitch: _____ /12 OR Slope: _____ degrees
--	--

Rafter: Size: <input type="checkbox"/> 2x4 <input type="checkbox"/> 2x6 <input type="checkbox"/> 2x8 <input type="checkbox"/> 2x10 <input type="checkbox"/> 2x12 <input type="checkbox"/> Other: _____ Spacing: <input type="checkbox"/> 16" o.c. <input type="checkbox"/> 24" o.c. <input type="checkbox"/> Other: _____ Grade: (if possible) _____	Floor Joist: Size: <input type="checkbox"/> 2x4 <input type="checkbox"/> 2x6 <input type="checkbox"/> 2x8 <input type="checkbox"/> 2x10 <input type="checkbox"/> 2x12 <input type="checkbox"/> Other: _____ Spacing: <input type="checkbox"/> 16" o.c. <input type="checkbox"/> 24" o.c. <input type="checkbox"/> Other: _____ Grade: (if possible) _____	Collar Tie: Size: <input type="checkbox"/> No Collar Tie <input type="checkbox"/> 2x4 <input type="checkbox"/> 2x6 <input type="checkbox"/> 2x8 <input type="checkbox"/> Other: _____ Spacing: <input type="checkbox"/> 16" o.c. <input type="checkbox"/> 24" o.c. <input type="checkbox"/> 32" o.c. <input type="checkbox"/> 48" o.c. <input type="checkbox"/> Other: _____ Grade: (if possible) _____
---	--	---

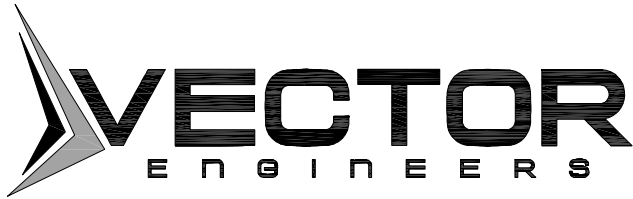

DRAPER, UTAH
(801) 990-1775
WWW.VECTORSOLAR.COM

Copyright © 2020
 Vector Structural Engineering, LLC
 This drawing contains proprietary information belonging to
 Vector Structural Engineering, LLC, and may be neither
 wholly nor partially copied or reproduced without the prior
 written permission of Vector Structural Engineering, LLC.

RAFTER & FLOOR JOIST
 ATTIC SPACE FINISHED
 w/ DORMER @ RIDGE

SURVEY TYPE: _____

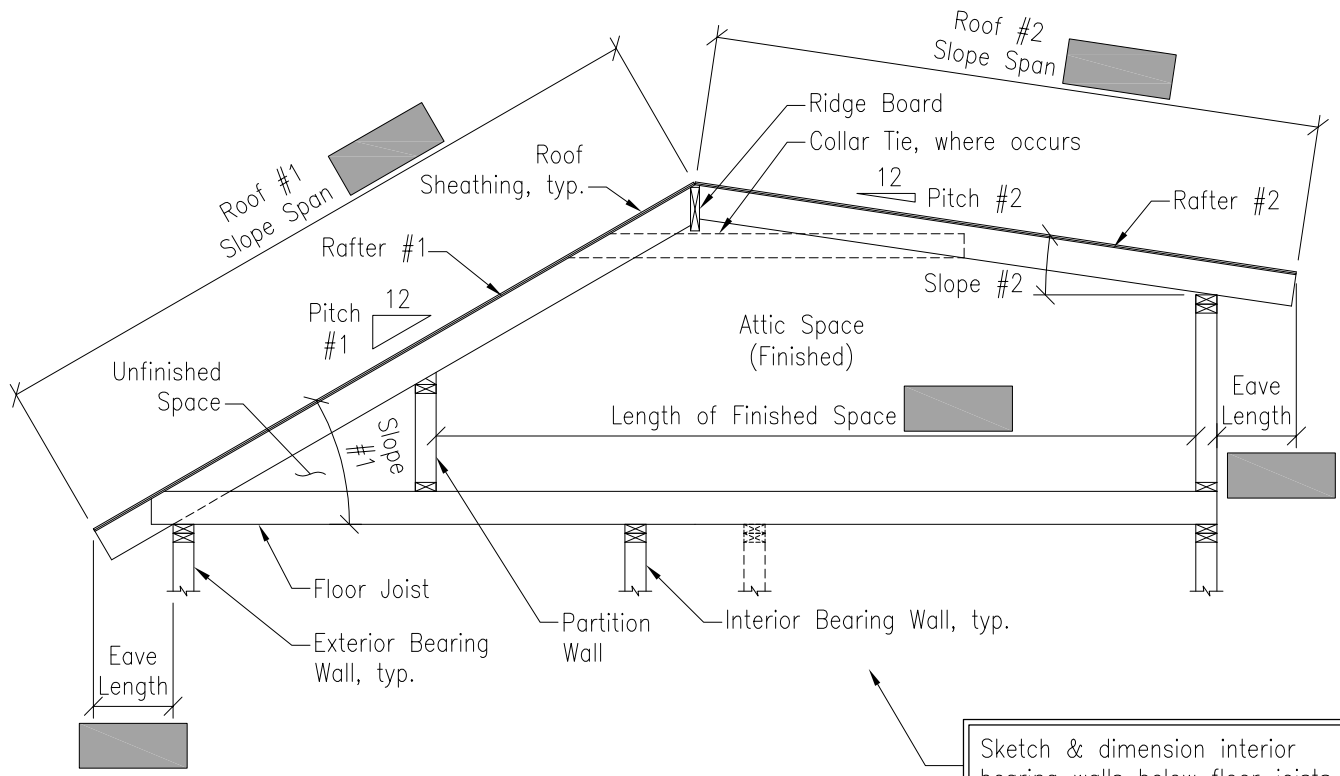

Roof Label/Identifier: _____

Roof Finish #1:	Roof Finish #2:	Slope:	
<input type="checkbox"/> Asphalt/Composite Shingles <input type="checkbox"/> Metal Seam <input type="checkbox"/> Corrugated Metal <input type="checkbox"/> Concrete Tile <input type="checkbox"/> Clay Tile <input type="checkbox"/> Other: _____	<input type="checkbox"/> Asphalt/Composite Shingles <input type="checkbox"/> Metal Seam <input type="checkbox"/> Corrugated Metal <input type="checkbox"/> Concrete Tile <input type="checkbox"/> Clay Tile <input type="checkbox"/> Other: _____	Pitch #1: _____ /12 OR Slope #1: _____ degrees	Pitch #2: _____ /12 OR Slope #2: _____ degrees

Rafter #1:	Rafter #2:	Floor Joist:	Collar Tie:
Size: <input type="checkbox"/> 2x4 <input type="checkbox"/> 2x6 <input type="checkbox"/> 2x8 <input type="checkbox"/> 2x10 <input type="checkbox"/> 2x12 <input type="checkbox"/> Other: _____ Spacing: <input type="checkbox"/> 16" o.c. <input type="checkbox"/> 24" o.c. <input type="checkbox"/> Other: _____ Grade: (if possible)	Size: <input type="checkbox"/> 2x4 <input type="checkbox"/> 2x6 <input type="checkbox"/> 2x8 <input type="checkbox"/> 2x10 <input type="checkbox"/> 2x12 <input type="checkbox"/> Other: _____ Spacing: <input type="checkbox"/> 16" o.c. <input type="checkbox"/> 24" o.c. <input type="checkbox"/> Other: _____ Grade: (if possible)	Size: <input type="checkbox"/> 2x4 <input type="checkbox"/> 2x6 <input type="checkbox"/> 2x8 <input type="checkbox"/> 2x10 <input type="checkbox"/> 2x12 <input type="checkbox"/> Other: _____ Spacing: <input type="checkbox"/> 16" o.c. <input type="checkbox"/> 24" o.c. <input type="checkbox"/> Other: _____ Grade: (if possible)	Size: <input type="checkbox"/> No Collar Tie <input type="checkbox"/> 2x4 <input type="checkbox"/> 2x6 <input type="checkbox"/> 2x8 <input type="checkbox"/> Other: _____ Spacing: <input type="checkbox"/> 16" o.c. <input type="checkbox"/> 24" o.c. <input type="checkbox"/> 32" o.c. <input type="checkbox"/> 48" o.c. <input type="checkbox"/> Other: _____ Grade: (if possible)



DRAPER, UTAH
(801) 990-1775
WWW.VECTORSOLAR.COM

Copyright © 2020
 Vector Structural Engineering, LLC
 This drawing contains proprietary information belonging to
 Vector Structural Engineering, LLC, and may be neither
 wholly nor partially copied or reproduced without the prior
 written permission of Vector Structural Engineering, LLC.

RAFTER & FLOOR JOIST
 ATTIC SPACE FINISHED
 SURVEY TYPE: w/ DORMER BELOW RIDGE

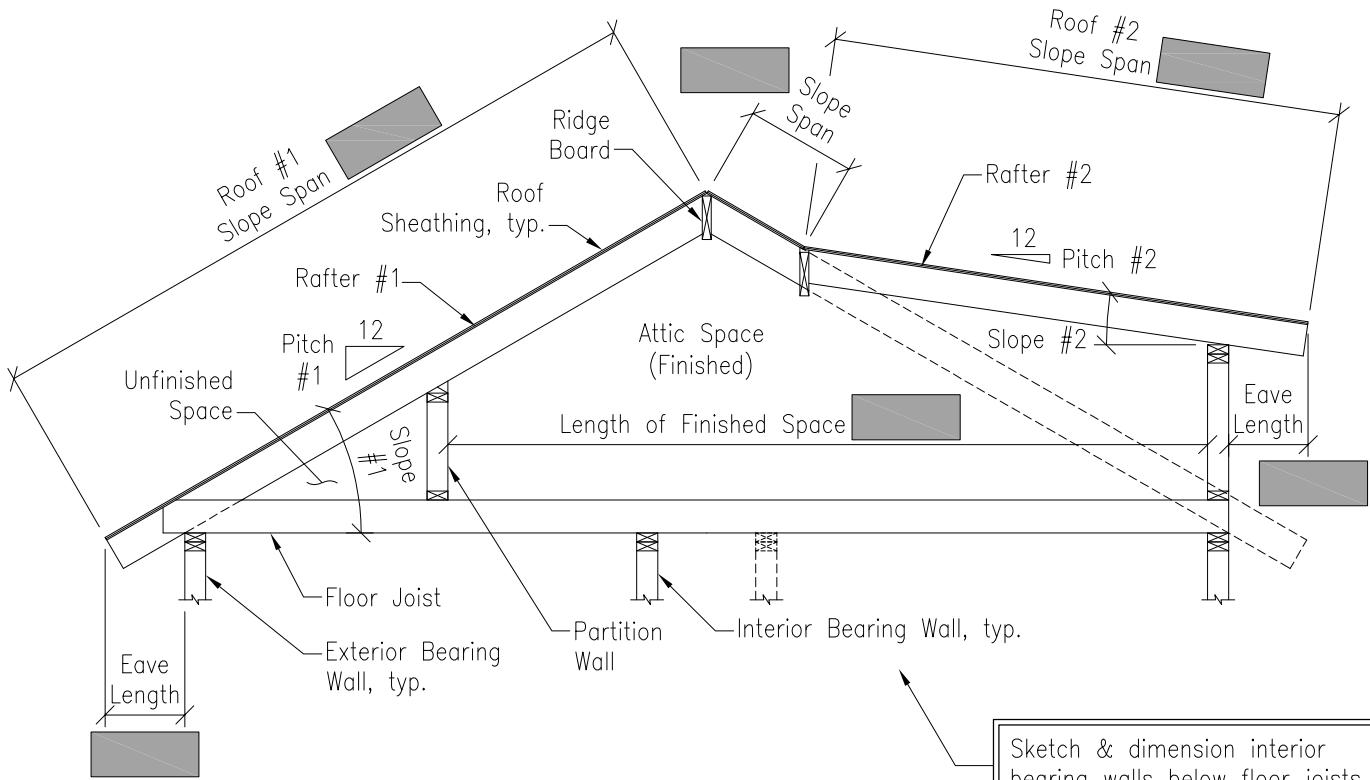

Roof Label/Identifier: _____

Roof Finish #1:		Roof Finish #2:		Slope:	
<input type="checkbox"/> Asphalt/Composite Shingles	<input type="checkbox"/> Asphalt/Composite Shingles	<input type="checkbox"/> Asphalt/Composite Shingles	<input type="checkbox"/> Asphalt/Composite Shingles	Pitch #1: _____ /12	Pitch #2: _____ /12
<input type="checkbox"/> Metal Seam	<input type="checkbox"/> Metal Seam	<input type="checkbox"/> Metal Seam	<input type="checkbox"/> Metal Seam	OR	OR
<input type="checkbox"/> Corrugated Metal	<input type="checkbox"/> Corrugated Metal	<input type="checkbox"/> Corrugated Metal	<input type="checkbox"/> Corrugated Metal	Slope #1: _____ degrees	Slope #2: _____ degrees
<input type="checkbox"/> Concrete Tile	<input type="checkbox"/> Concrete Tile	<input type="checkbox"/> Concrete Tile	<input type="checkbox"/> Concrete Tile		
<input type="checkbox"/> Clay Tile	<input type="checkbox"/> Clay Tile	<input type="checkbox"/> Clay Tile	<input type="checkbox"/> Clay Tile		
<input type="checkbox"/> Other: _____	<input type="checkbox"/> Other: _____	<input type="checkbox"/> Other: _____	<input type="checkbox"/> Other: _____		

Rafter #1:	Rafter #2:	Floor Joist:	Collar Tie:
Size:	Size:	Size:	Size:
<input type="checkbox"/> 2x4	<input type="checkbox"/> 2x4	<input type="checkbox"/> 2x4	<input type="checkbox"/> No Collar Tie
<input type="checkbox"/> 2x6	<input type="checkbox"/> 2x6	<input type="checkbox"/> 2x6	<input type="checkbox"/> 2x4
<input type="checkbox"/> 2x8	<input type="checkbox"/> 2x8	<input type="checkbox"/> 2x8	<input type="checkbox"/> 2x6
<input type="checkbox"/> 2x10	<input type="checkbox"/> 2x10	<input type="checkbox"/> 2x10	<input type="checkbox"/> 2x8
<input type="checkbox"/> 2x12	<input type="checkbox"/> 2x12	<input type="checkbox"/> 2x12	<input type="checkbox"/> Other: _____
<input type="checkbox"/> Other: _____	<input type="checkbox"/> Other: _____	<input type="checkbox"/> Other: _____	Spacing:
Spacing:	Spacing:	Spacing:	<input type="checkbox"/> 16" o.c.
<input type="checkbox"/> 16" o.c.	<input type="checkbox"/> 16" o.c.	<input type="checkbox"/> 16" o.c.	<input type="checkbox"/> 24" o.c.
<input type="checkbox"/> 24" o.c.	<input type="checkbox"/> 24" o.c.	<input type="checkbox"/> 24" o.c.	<input type="checkbox"/> 32" o.c.
<input type="checkbox"/> Other: _____	<input type="checkbox"/> Other: _____	<input type="checkbox"/> Other: _____	<input type="checkbox"/> 48" o.c.
Grade: (if possible)	Grade: (if possible)	Grade: (if possible)	<input type="checkbox"/> Other: _____
_____	_____	_____	Grade: (if possible)

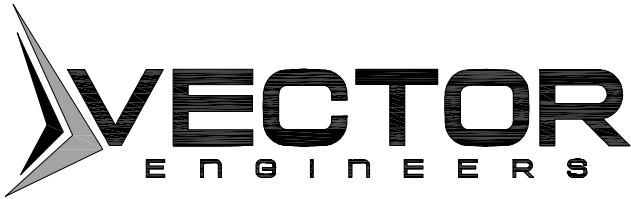

DRAPER, UTAH
 (801) 990-1775
 WWW.VECTORSOLAR.COM

Copyright © 2020
 Vector Structural Engineering, LLC
 This drawing contains proprietary information belonging to
 Vector Structural Engineering, LLC, and may be neither
 wholly nor partially copied or reproduced without the prior
 written permission of Vector Structural Engineering, LLC.

SURVEY TYPE: SLOPE MANUFACTURED TRUSS

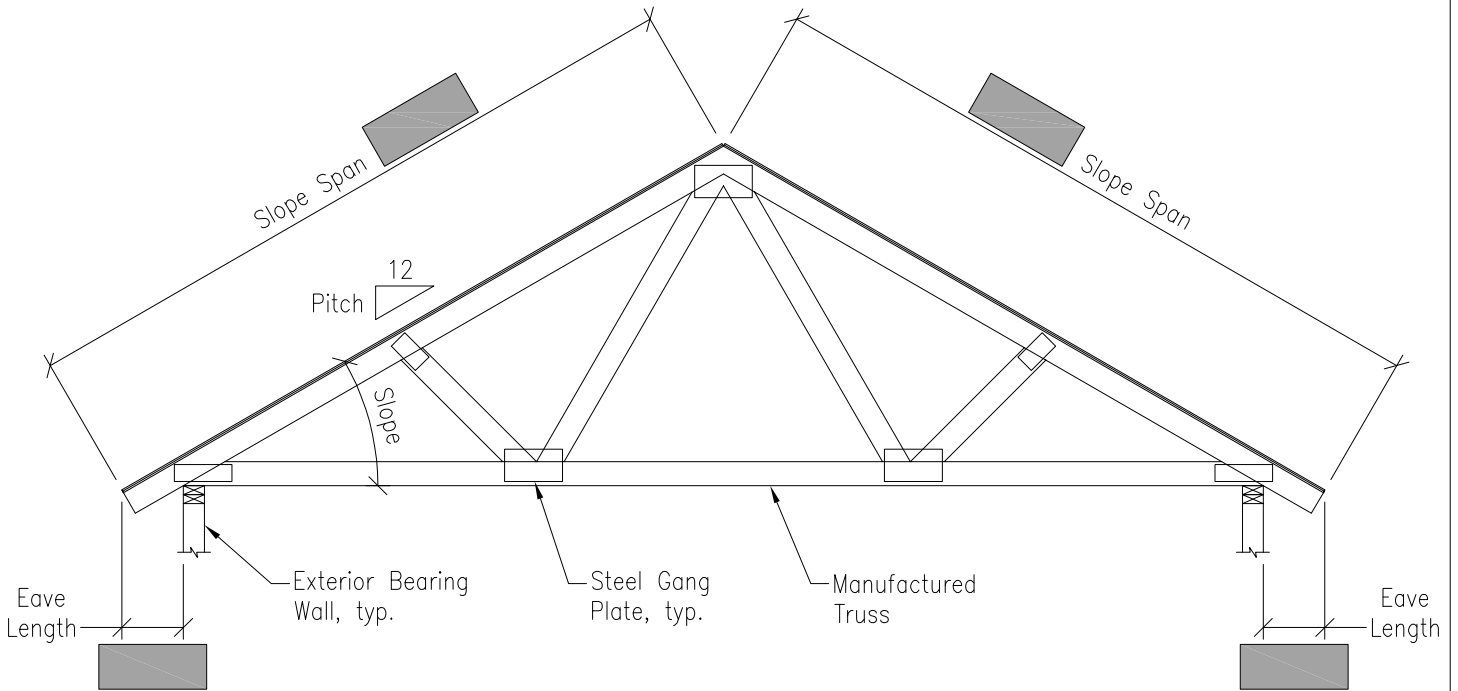

Roof Label/Identifier: _____

Roof Finish: <ul style="list-style-type: none"> <input type="checkbox"/> Asphalt/Composite Shingles <input type="checkbox"/> Metal Seam <input type="checkbox"/> Corrugated Metal <input type="checkbox"/> Concrete Tile <input type="checkbox"/> Clay Tile <input type="checkbox"/> Other: _____ 	Slope: _____ Pitch: _____ / 12 OR Slope: _____ degrees
---	---

Truss:

Top Chord Size:

- 2x4
- 2x6
- Other: _____

Spacing:

- 16" o.c.
- 24" o.c.
- Other: _____

Grade: (if possible)
